



ZHAILAU 2010
Kazakh Heritage Camp for Families
July 26-31, 2010

GENERAL INFORMATION GUIDE

The Kazakh Aul of the US is thrilled to announce the sixth annual *Zhailau* Kazakh Heritage Camp for Families. *Zhailau* means the summer encampment or home of the Kazakh nomads, and we at the Aul are delighted to announce that our 5-night all-inclusive Zhailau will be held once again at the Geneva Point Center located on 200 acres of beautiful Lake Winnepesaukee waterfront in New Hampshire.

Our Zhailau camp will be a special time devoted to celebrating the wonderful culture of Kazakhstan, to providing an opportunity to bring children and families together, all while taking advantage of the wide range of recreational programming and facilities that the Geneva Point Center has to offer. Zhailau 2010 promises to be a wonderful opportunity for families to come together, to relax together, to eat, to play, and to celebrate our children's birth culture – together as a 'village,' our *Aul*.

This 5-night retreat is an **ALL-INCLUSIVE** event. The price you pay includes lodging, all meals, and participation in all activities at the camp. Families can choose from among the various Geneva Point accommodations the type that best meets their budget and lifestyle – a rustic simple room in a lodge or cabin, or camping.

The Aul will be conducting Kazakh cultural activities throughout each morning and whole-group activities will be offered most evenings (see tentative schedule on page 3). We are privileged that many of our Kazakh teachers will be returning this year to guide and instruct us in Kazakh culture, including:

- Aizhan Tuleubayeva (New York) and Samal Shaikenova of Trio NazIm (Texas). Aizhan (qobiz) and Samal (dombra) are talented musicians from Kazakh folk orchestras. Aizhan taught at Zhailau in 2008 and 2009, Samal in 2008.
- Ballerina Dilara Shomayeva will be traveling once again from Almaty to teach Kazakh dance. Dilara was with us in 2008.
- Ulan Toktarov (New York) is returning to work on Kazakh language and games. Ulan was with us in 2009
- **New staff addition: Experienced Kazakh language teacher, Alma Tagasheva. Alma currently gives weekly Kazakh language classes to children in New York City.

The Zhailau planning committee is excited to announce an expansion of programming for children nine years and older. In addition, the Zhailau planning committee is working hard to put together additional cultural activities, children's crafts, culture presentations/discussions, and Kazakh cooking. Planned Kazakh cultural program offerings include:

- Music Performances by Aizhan and Samal. Dance performance by Dilara.
- Dombra and Kazakh folk music workshops
- Kazakh language workshops
- Kazakh dance lessons
- Kazakh crafts
- Kazakh field games
- New programming for older children
- Archery
- Kazakh traditional cooking
- Zharmenke (Kazakh Trade Fair, Aul store)
- And more.....

Important note regarding Zhailau 2010 cultural programming: Due to family commitments, Daniyar and Assylgul Baidaralin are not able to participate in Zhailau this year. For those who have not yet attended Zhailau, Daniyar traditionally directs the Aul's Zhailau cultural programming and has taught families a great deal with respect to Kazakh traditions. The Zhailau 2010 organizers will be doing our best to continue the wonderful Zhailau traditions that Daniyar has taught, and continues to teach, our Aul. We will miss Daniyar and Assylgul very much, but we are very fortunate to have wonderful Kazakh staff this year

In addition, we will not be able to raise the yurt this summer. The yurt is in need of major repair and cannot be raised this year. We look forward to raising it at future Zhailaus. While we will miss gathering in the yurt, we look forward to a wonderful families' reunion this July, replete with many of the wonderful traditions of our young Aul.

Old-fashioned camp activities. In addition to Kazakh cultural programming, campers will have most afternoons as "Aul social time," when participants can select from the many recreational activities offered by the Geneva Point Center that include:

- ✦ Waterfront: Beaches are supervised by certified lifeguards. Come down to the one of three beaches for swimming, canoeing, kayaking, paddleboat, water carnivals, and organized canoe trips
- ✦ Two playgrounds
- ✦ On-site and off-site hiking
- ✦ A softball field and two clay tennis courts (equipment is available)

Zhailau is an entirely volunteer-run event in which all Aul community members present at Zhailau play an important role. Each adult attendee will sign up to assist in at least two organized activities during the week. This effort serves to keep Zhailau fees down, and in the traditional Kazakh way, also helps to build community by involving all adult participants in running Zhailau. Activities may include camp registration, Kazakh cooking, assisting with crafts, games, technology support, or packing up. Sign-up forms are included in the Zhailau 2010 registration materials that appear at the end of this General Information Guide. *Note: single parents who feel they may not be able to make child care arrangements may opt out.*

Meals. Our group will eat three buffet-style meals together each day, and for vegetarians, please note that a vegetarian option will be offered at each meal.

IMPORTANT NOTE REGARDING RESPONSIBILITY FOR THE CARE AND SUPERVISION OF CHILDREN:

- ✦ Parents are responsible at all times for their children at Zhailau. The Kazakh Aul of the US cannot and will not assume responsibility for the care or supervision of people's children.
- ✦ The Geneva Point Center's new executive director has informed us that ALL children, regardless of age, must be supervised by an adult at all times. This includes anyone under the age of 16.
- ✦ It is the responsibility of the parent or guardian to ensure that his/her child(ren) are respectful of Geneva Point Center and Kazakh Aul of the US property (e.g., equipment, games, books, facilities, instruments, etc.). Parents will compensate the Geneva Point Center and/or the Kazakh Aul of the US for any damages incurred by themselves or their children.
- ✦ Due to safety concerns, NO children under the age of 18 will be allowed into the cooking area during Kazakh Cooking.
- ✦ Bike riders are required to wear helmets at all times, must yield to pedestrians in walkways, observe reasonable speeds, and must respond immediately to any adult request to stop or reduce speed. A formal written bicycle riding permission policy will be sent to all families. Bicycle riding at Zhailau is a privilege which can be revoked by the Kazakh Aul of the US or the Geneva Point Center

THE ZHAILAU PLANNING COMMITTEE IS COMPRISED FULLY OF PARENT VOLUNTEERS. Please know that the materials you are reading, all camp organization, answering of phones, emails, planning, you name it – all are produced or coordinated by volunteers, all of whom also have day jobs. The Zhailau planning committee is staffed this year by Jeanne Carrillo, Audrey Englander, Heather O’Toole, and Susan Saxon. The Committee welcomes your support if you have time to donate.

Tentative Schedule. The following table displays a tentative schedule for the Aul’s 5-night camp. Please note that the schedule is a still a work in progress as the Zhailau planning committee strives to make camp as enjoyable and fulfilling as possible.

Day	Mornings – Kazakh Culture Activities	Afternoons - Open time	Evenings (after dinner)
Mon. 7/26		Guests arrive Check in 2pm	Welcoming ceremony and ice cream social
Tues. 7/27	Dombra & Qobiz Exploration, Kazakh Crafts, Kazakh Language Dombra lessons, Water Carnival	<i>Optional activities:</i> Canoe trip, swimming	Kazakh Disco
Wed., 7/28	Dombra & Qobiz Exploration, Kazakh Crafts, Kazakh Language Dombra lessons, Water Carnival	<i>Optional activities:</i> Nature hike, water activities	Campfire
Thurs., 7/29	Kazakh cooking, Field Games, <i>Zharmenke</i> (Trade Fair),	Zhailau lunch, Archery, Canoe trip	Kazakh story dramatizations and silent auction
Fri., 7/30	Dombra & Qobiz Exploration, Kazakh Crafts, Kazakh Language Dombra lessons, Water Carnival	Rehearsals for Closing Ceremonies <i>Optional activity:</i> Learning about loons nature program	Closing ceremonies at the Tree of Life, campfire
Sat., 7/31	Checkout by 10am		

ACCOMMODATIONS

A variety of rustic accommodations are offered to meet the needs of different budgets and needs. You may camp or stay in a rustic cabin or lodge.

Note that the Gibbes House, Lake View Cabins, and Lake View Lodge are all located in relatively close proximity to one another. The camping site is located about a 5 minute walk from the other Aul housing (see Geneva Point Center map on page 7).

The Lake View Cabins and Gibbes House offer different bed configurations options across different units; if you choose one of these two housing options, please make sure you note on the registration form your preferred bed configuration (see housing descriptions below).

Please know that the Aul will make every effort to accommodate your housing choices, but cannot guarantee them, as all housing will be assigned based on need and a first-come first served basis.

The following are the available housing choices:

Emily V. Gibbes House Each of 10 rustic rooms in this lodge has carpeting, bathroom with shower, and entrance from hallway. Four rooms have a double bed and 1 full-size sofa-sleeper. Four rooms have 2 twin beds and a full size sofa-sleeper and 2 rooms have two twin beds with room for a roll-a-way. One room is barrier free with 2 twin beds and full paraplegic bathroom. The house has a common area that includes a kitchenette and living room. An exterior photo of this house may be viewed at <http://www.genevapoint.org/gibbesenlarged.html>.

Accommodations (continued).

Lake View Cabins Four cabins with two rustic units each (eight units total), each of which has carpeting, bathroom with shower, and a shared porch. Six of the units have two twin beds each, of which two units have room for a roll-a-way. The remaining two units each have one queen bed and a day bed. A photo of the exterior of one cabin is provided at <http://www.genevapoint.org/resources.html> (note: scroll down the page to see the Lakeview cabin).

Lake View Lodge This 10-room lodge is situated on the Lake Winnepesaukee waterfront. Each unit has 2 double beds, carpeting, bathroom with shower, private entrance, and room for a rollaway (rollaways may be rented for an additional \$25 per week). Minimum of 1 adult & 2 children charge per room. An exterior photo may be viewed at <http://www.genevapoint.org/resources.html>.

Camping Bring your own tent and equipment. Toilets and showers are available in the shower house. Cooking and campfires are not allowed. Tenters will eat their meals together with the whole Aul group.

Accommodations will be assigned by the Kazakh Aul of the US based on need and a first-come, first served basis upon receipt by the Aul of a completed registration form with a non-refundable 1st deposit of \$150 per family member attending until all accommodations are full. Deposits will be accepted for the full 5-night camp only.

RATES

The determination of camp fees is always a balancing act between trying to cover the Zhailau budget and realistically estimating the number of families who may attend. The Kazakh Aul of the US strives to keep attendees fees as affordable as possible.

For 2010, the Geneva Point Center significantly increased our group fees, plus our staffing and programming expenses have considerably increased. Also, a new Geneva Point Center fee structure has in turn affected how the Aul sets the fee structure for Zhailau attendees.

The Kazakh Aul of the US has had to increase most Zhailau rates. Those who attended Zhailau previously will note that instead of separate charges for single and adult occupancy, there is now just one adult rate. Expansions in Aul children's programming are also reflected in the new fee structure.

It is important to note that proceeds from Zhailau fees will cover only about one-half of the Aul's projected Zhailau budget increase.

Because proceeds from attendees' fees may not cover the full cost of Zhailau 2010, please consider making a tax deductible contribution to the Kazakh Aul of the US to help defray the costs of Zhailau using the Optional Donation line in the Zhailau registration materials.

* * * * *

Zhailau rates listed below are per person and vary depending upon the type of accommodation selected. Rates include three meals per day, Kazakh culture programs, administrative costs, and all costs associated with programming, including compensation for educators, materials, supplies, and transportation. The Geneva Point Center's facilities and programming, such as the private beach on Lake Winnepesaukee, lifeguards, canoes, kayaks, canoe trips, playground, playing fields, and hiking trails, are also included.

Rates (continued).

Minimum occupancy charge per unit is 1 adult & 1 child, excluding camping and Lake View Lodge. The minimum occupancy charge for rooms in the Lake View Lodge is 1 adult & 2 children.

Zhailau 2010 rates vary according time of receipt by the Kazakh Aul of the US of first deposit and registration forms. There are two levels of fees: *Early Bird Rates* or *Standard Rates*.

The Early Bird rate offers a substantial savings over the Standard Rate. Early Bird registration materials must be postmarked by February 22, 2010. The deadline for registration at the Standard rates is April 30, 2010. Anyone requesting to attend after April 30th must pay the balance in full at the time of registration.

EARLY BIRD RATES			
Applicable when registration and 1 st deposit received <u>by FEBRUARY 22, 2010</u>			
ALL-INCLUSIVE RATES PER INDIVIDUAL FOR ZHAILAU JULY 26-31, 2010	Adult Occupancy	Children when Sharing with Families	
		Ages 9-15	Ages 2-8
Camping (bring your own tent and equipment)	\$419	\$309	\$259
Emily V. Gibbes House, Lake View Cabins, Lake View Lodge	\$709	\$439	\$389

STANDARD RATES			
Applicable when registration and 1 st deposit received <u>FEBRUARY 23, 2010 or later</u>			
ALL-INCLUSIVE RATES PER INDIVIDUAL FOR ZHAILAU JULY 26-31, 2010	Adult Occupancy	Children when Sharing with Families	
		Ages 9-15	Ages 2-8
Camping (bring your own tent and equipment)	\$519	\$409	\$359
Emily V. Gibbes House, Lake View Cabins, Lake View Lodge	\$809	\$539	\$489

TESTIMONIALS

“Catherine and I would like to extend our heartfelt thanks to the Zhailau 2007 planning committee. It was evident that you all put an amazing amount of work into it and that you put your hearts and souls into making it a success. From our perspective, it seemed effortless. Everything was so well planned and easy. We simply went with the flow and enjoyed every minute of it. The little details and extra touches were so appreciated (such as popcorn at the movie)...We also made many wonderful friends. We truly felt a sense of community and what a special Aul we are. We plan to stay in touch and if all works out to see you next year!”

Tracey Croccoll, Minnesota

“We were thrilled that we were able to meet and spend time with successful and friendly and warm Kazakh people who came to share their craft and skills and stories and heartfelt connections with all of us. We came away with new friends; a deeper appreciation for and wonderment about Kazakh culture; an added celebration of Saida’s Kazakh heritage, and left the week with Saida saying “I don’t want to leave...we are coming again next year, right?” What could be a better testament to how she felt about Zhailau! And truly, we felt just the same! Thanks again, for all the preparation and work and late nights and energy and caring it took to host such a meaningful and fun event. We absolutely loved it!”

Alicia, Bruce, and Saida Riddell, Maine

“I too would like to chime-in and say thank you to everyone for such a wonderful week. Nicholas and I can't seem to stop talking about what a great time we had and about the wonderful people we met. The community spirit that was felt throughout the week was magical, learning about the Kazakh culture was fascinating, and the view with the lake was very relaxing. We look forward to coming back next year.”

Liz Wellman, Georgia

“But for the amazing work of the organizers and board members, it was a completely relaxed and peaceful time in which boys and girls of all ages got along wonderfully doing simple things. It was just the opposite of a Disney type vacation, and better. I think in the future the children will all look back with fondness at those wholesome and priceless times. No changes could improve it, as I don’t think it can get any better.”

David Morowitz, Rhode Island

“[My 18-month-old daughter] can’t tell me much yet, but since Zhailau, I am convinced that through our participation in this U.S.-Kazakh community she tells me a lot. Before Zhailau, Alma was a very clingy child, never daring to venture far from me and expressing her dissatisfaction at every separation. But at Zhailau, I saw a different side of Alma. She willingly and joyfully went to her Kazakh counselors, and would even wander away from us when she noticed other Kazakh children playing nearby. I know that experts in child development might argue that Alma had just reached a new stage, that she was ready to begin testing her independence. But whenever I look at our pictures from Zhailau, whenever I see Alma dancing with Karina (one of our Kazakh counselors), banging away on a dombra, sharing her toys with her new friend Aliya, or digging in the dirt with her new buddy Nina, I believe that Alma is telling me something about herself and the way her cultural heritage has already influenced who she is. And I feel such gratitude for this community and the way it helps me to better know this child whom I love so dearly.”

Elana Peled, Massachusetts

Geneva Point Center

Moultonboro, New Hampshire

603-253-4366

www.genevapoint.org

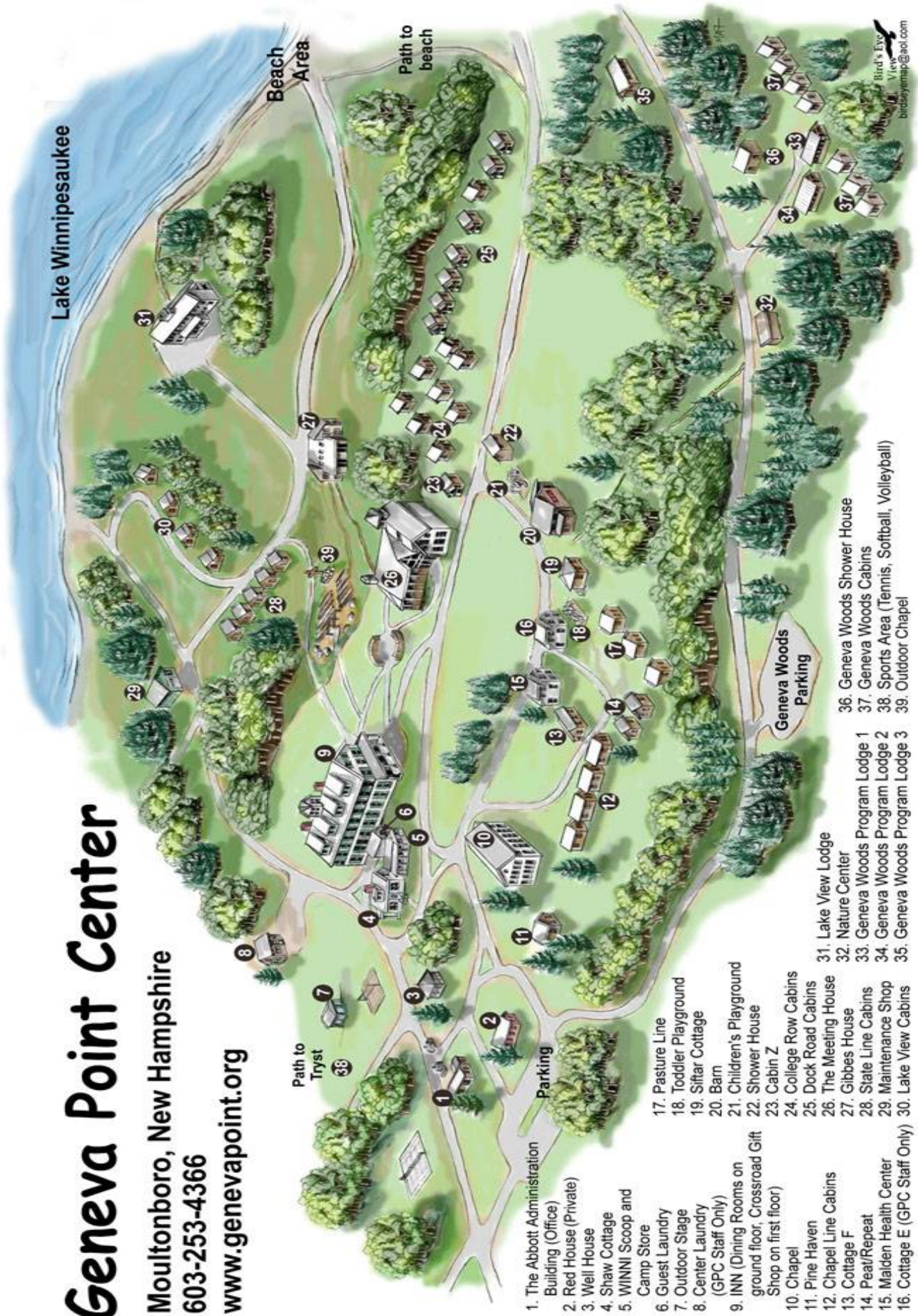

- 1. The Abbott Administration Building (Office)
- 2. Red House (Private)
- 3. Well House
- 4. Shaw Cottage
- 5. WINNI Scoop and Camp Store
- 6. Guest Laundry
- 7. Outdoor Stage
- 8. Center Laundry (GPC Staff Only)
- 9. INN (Dining Rooms on ground floor, Crossroad Gift Shop on first floor)
- 10. Chapel
- 11. Pine Haven
- 12. Chapel Line Cabins
- 13. Cottage F
- 14. Peat/Repeat
- 15. Malden Health Center
- 16. Cottage E (GPC Staff Only)
- 17. Pasture Line
- 18. Toddler Playground
- 19. Sifter Cottage
- 20. Barn
- 21. Children's Playground
- 22. Shower House
- 23. Cabin Z
- 24. College Row Cabins
- 25. Dock Road Cabins
- 26. The Meeting House
- 27. Gibbs House
- 28. State Line Cabins
- 29. Maintenance Shop
- 30. Lake View Cabins
- 31. Lake View Lodge
- 32. Nature Center
- 33. Geneva Woods Program Lodge 1
- 34. Geneva Woods Program Lodge 2
- 35. Geneva Woods Program Lodge 3
- 36. Geneva Woods Shower House
- 37. Geneva Woods Cabins
- 38. Sports Area (Tennis, Softball, Volleyball)
- 39. Outdoor Chapel

Directions to the Geneva Point Center

The closest airport is in Manchester, NH, which is about 1 ½ hours south of Geneva Point. Many major airlines service Manchester including Southwest, United, US Airways, Delta, Northwest, and Continental. If you fly into Manchester, you can rent a car and drive to Geneva Point using the driving directions below.

Alternatively, Boston is 2 ½ hours by car from Geneva Point. If you fly in to Logan Airport, you can rent a car and drive to Geneva Point. Or, you can take a bus either from the airport or Boston's South Station to Center Harbor, NH, and with notice, we could arrange for someone to pick you up. The Geneva Point Center charges \$10 (rate subject to change) for up to 3 people to be picked up in Center Harbor. If you are interested in the bus, you can investigate this option at <http://www.concordrailways.com/>. Please let the Aul know *in advance* if you will need to be picked up in Center Harbor.

Driving directions from the South: Take I-93 North to exit 23 and turn right onto route 104 for 9 miles. At the junction of Route 104 and U.S. Route 3, take a left onto Route 3 for approximately 1 mile. At the traffic lights in Meredith, bear right onto Route 25 (stay on Route 25) for 8 miles. Take a right onto Moultonboro Neck Road at the traffic lights (just beyond the Service Station) and travel for 5.7 miles. Bear left at fork in the road. Turn left onto Geneva Point Road and follow to the Geneva Point Center entrance sign.

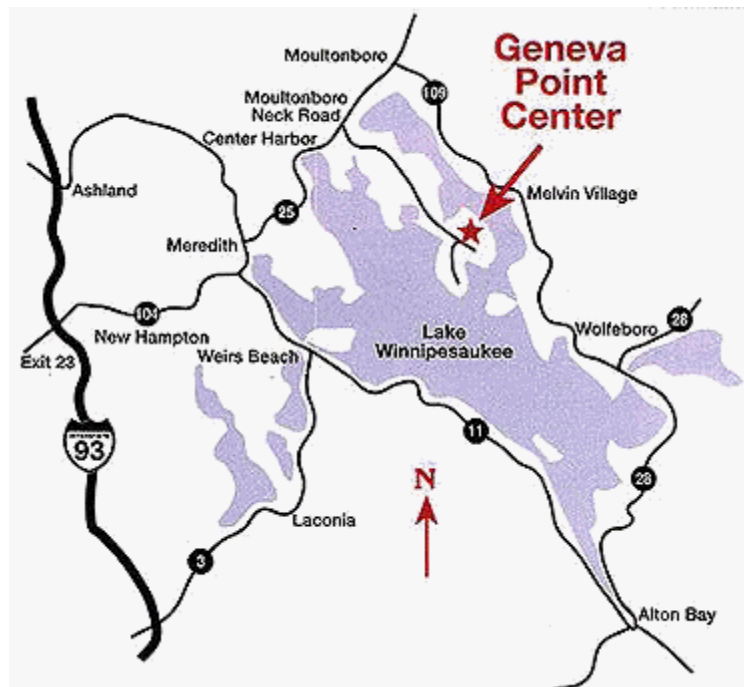

Driving address: 108 Geneva Point Rd, Moultonborough, NH